

HORIZONTAL SPLIT CASING PUMP

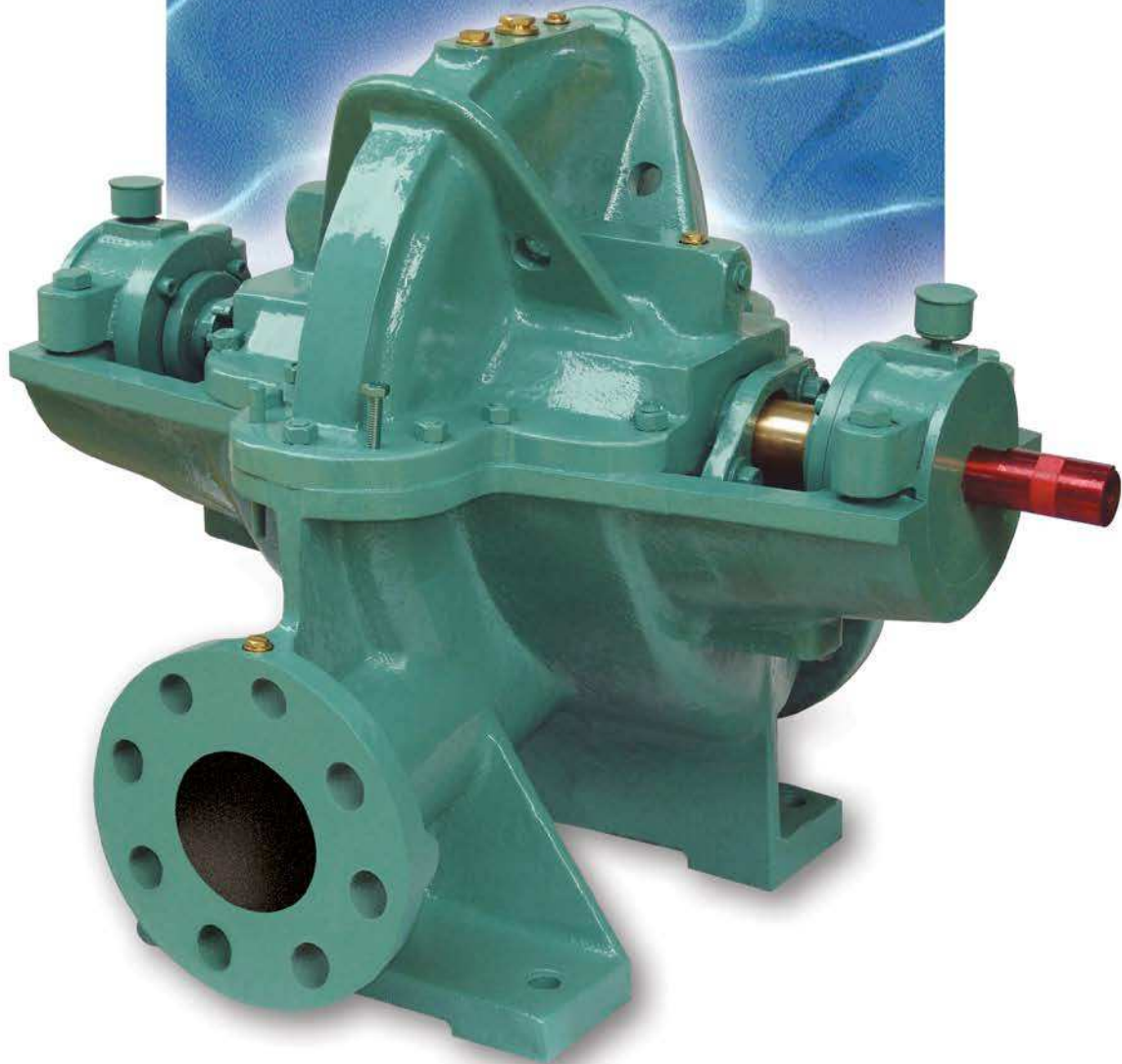

MBH[®]
PUMPS

A Mark of Quality



HORIZONTAL

PUMP CONSTRUCTION

MBH Horizontal Split Casing Pumps - a new concept for better performance and higher efficiencies. For greater interchangeability and ease of maintenance, MBH Horizontal Split Casing Pumps allow easy access to facilitate maintenance and inspection of rotor assembly without disturbing pipe connectors and prime mover.

These MBH Horizontal Split Casing Pumps give higher efficiencies, stable head and non over loading power characteristics with better suction capabilities.

The Pumps are available in standard cast iron construction or in bronze, bronze fitted and stainless steel materials.

APPLICATIONS :

Air-Conditioning, Fire-Fighting, Irrigation, Water supply schemes, Industrial water supply, Oil refineries and Fertilizer plants, Mines, Steel and Cement plants, etc.

CASING : Horizontal axially split volute type, suction and discharge nozzles and supporting feet are cast integral with lower half casing.

IMPELLER : Double or single suction type accurately balanced. In the case of double suction impellers, the hydraulic thrust is balanced automatically because of pressure equalization on both sides of the impeller.

SHAFT : The high tensile shaft accurately machined and ground is supported by antifriction bearings. Shaft sleeves from wear in stuffing box area protect the shaft.

STUFFING BOX : Can be sealed by gland packing or by mechanical seal and is suitable for liquids having temperature up to 90° C.

BEARINGS : Deep groove ball / roller bearings are provided. Standard lubrication is grease.

DIRECTION OF ROTATION :

Standard - Anticlockwise viewed from driving end.
Optional - Clockwise viewed from driving end.

DRIVE : Suitable for coupling with electric motors, I.C. engines or steam turbines either directly or through belt drives, gearboxes etc.

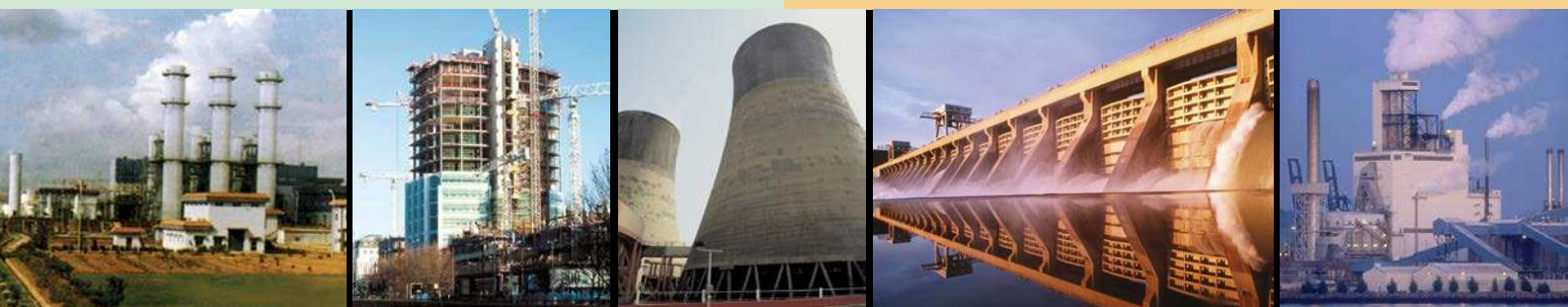

SPLIT CASING PUMP

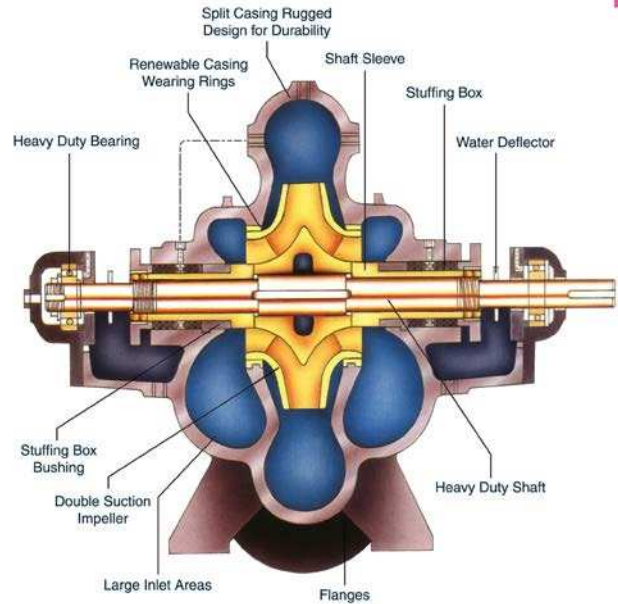

General Cross Section Arrangement

FEATURES

- Rotating assembly available for inspection or maintenance by removing upper half casing without disturbing suction, delivery piping and motor.
- Highest hydraulic and overall efficiency due to latest design and manufacturing techniques.
- Very high efficiency in the operating range.
- Good suction performance and low NPSH.
- Stable characteristics.
- Minimum maintenance.
- Highest reliability.

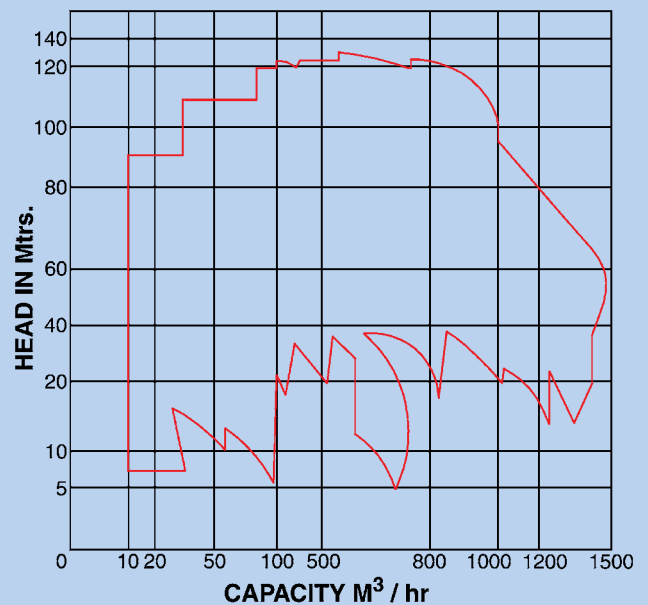

Our Product Range



**CENTRIFUGAL
PUMP TYPE HC**



**PORTABLE
SUBMERSIBLE PUMP**



**SUBMERSIBLE
SEWAGE PUMP**



**POLDER /
DEWATERING PUMP**



**SELF PRIMING
CENTRIFUGAL PUMP**

As improvements are made in design from time to time, specifications and performance are subject to change without prior notice.

MBH[®] **PUMPS**



**ISO 9001:2008
Certified Company**

mbh pumps (gujarat) pvt. ltd.

Office & Factory :

Plot No. 14, G.I.D.C. Naroda Indl. Estate,
Ahmedabad - 382 330, India.

Phone : +91-79-2282 3066, 2282 1018

E-mail : marketing@mbhpumps.com

Website : www.mbhpumps.com

Authorised Dealer :

Horizontal Split Casing Pumps

Cross Section

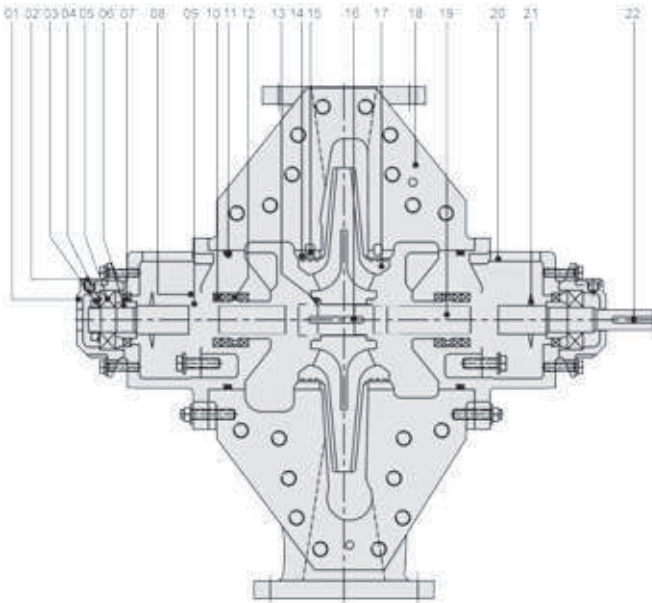

NO.	DESCRIPTION	MATERIAL
1	BEARING COVER	C.I. IS - 210 FG 260
2	1/4" PLUG	S.S.
3	RING NUT	M.S.
4	STAR WASHER	M.S.
5	BALL BEARING	STD. MAKE
6	DISTANT PIECE	C.I.
7	OIL SEAL	NI. RUBBER
8	GLAND COVER	C.I. IS - 210 FG 260
9	PUMP SLEEVE	C.I. IS - 210 FG 260
10	GLAND PACKING	GR. ASBESTOS
11	"O" RING BEARING HOUSING	NI. RUBBER
12	LANTERN RING	PLASTIC
13	"O" RING PUMP SLEEVE	NI. RUBBER
14	NECK RING	C.I.
15	NECK RING LOCK RING	S.S.
16	IMPELLER KEY	EN- S.S.
17	IMPELLER	C.I. IS - 210 FG 260
18	LOWER CASING	C.I. IS - 210 FG 260
19	PUMP SHAFT	EN - S.S. 410
20	BEARING HOUSING	C.I. IS - 210 FG 260
21	RUBBER DEFLECTOR	NI. RUBBER
22	COUPLING KEY	EN - S.S.

GA Drawing

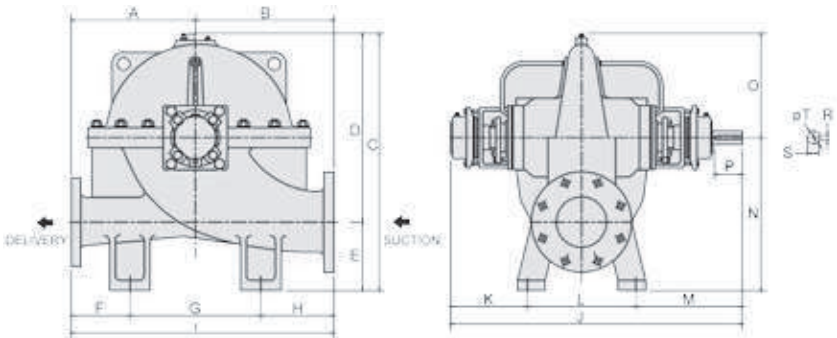

MODEL IDENTIFICATION

Example : PUMP MODEL MBH M-50-80-280

M	50	80	280
Difference of Head L - Low M - Middle H - High	Discharge Size	Suction Size	Impeller Dia in MM

All Dimension are in mm

MODEL	Suc.	Del.	A	B	C	D	E	F	G	H	I	J	K	L	M	N	O	P	R	S	T	Weight in KG.
MBH M-50-80-280	80	50	257	280	470	355	115	123	310	104	537	651	195	190	266	270	200	50	8	21	ø25	88
MBH H-80-100-370	100	80	285	340	586	452	136	117	340	168	625	704	217	220	267	304	284	50	8	21	ø25	173
MBH M-100-125-302	125	100	240	320	550	410	140	125	230	205	560	696	211	220	265	310	240	50	8	21	ø25	150
MBH H-100-125-360	125	100	309	345	642	472	170	146	325	183	654	739	192	270	277	380	262	70	10	30	ø35	260
MBH M-125-150-290	150	125	292	320	590	426	164	137	340	135	612	692	183	270	239	350	240	50	10	25	ø30	200
MBH H-125-150-410	150	125	339	372	702	538	164	148	360	202	710	741	200	250	291	405	297	70	10	30	ø35	285
MBH M-150-200-302	200	150	319	371	722	523	199	153	350	187	690	905	236	340	329	440	282	80	12	36.5	ø42	278
MBH H-150-200-364	200	150	310	410	680	500	180	135	350	235	720	872	237	310	325	390	290	87	12	36.5	ø42	310
MBH M-200-250-300	250	200	350	450	810	547	263	185	385	220	800	1037	285	380	372	513	297	80	12	36.5	ø42	400
MBH H-200-250-360	250	200	420	540	850	640	210	185	470	305	960	936	219	410	307	475	290	87	12	36.5	ø42	380

Horizontal Split Casing Pumps

Performance Curves • 1450 RPM (400/440 V, 3 Phase, 50 Hz, A.C. Supply)

Model : MBH-M-50-80-280

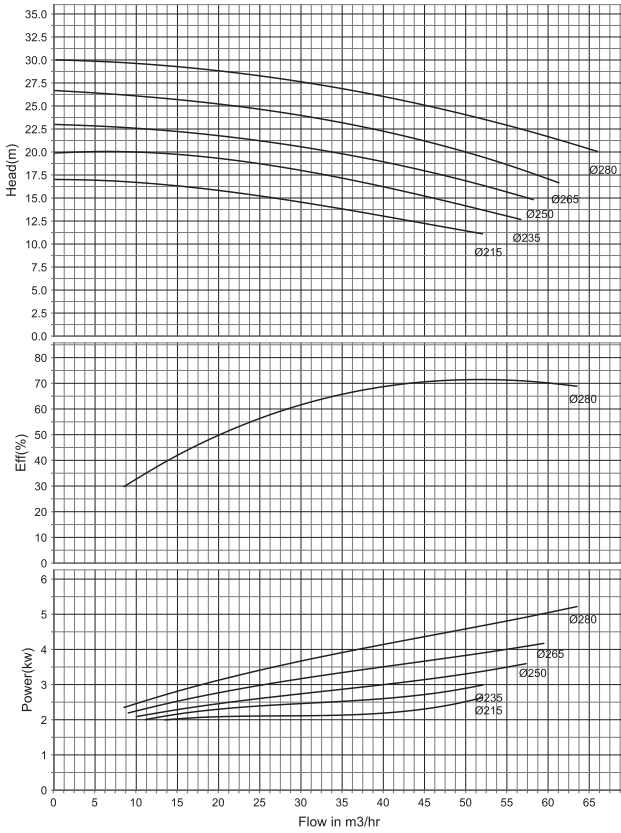

Model : MBH-H-80-100-370

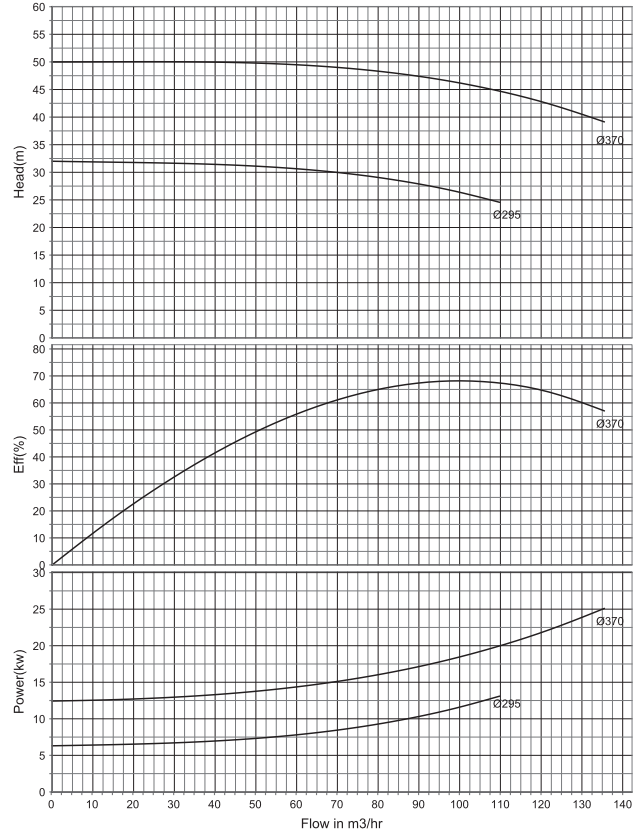

Model : MBH-M-100-125-302

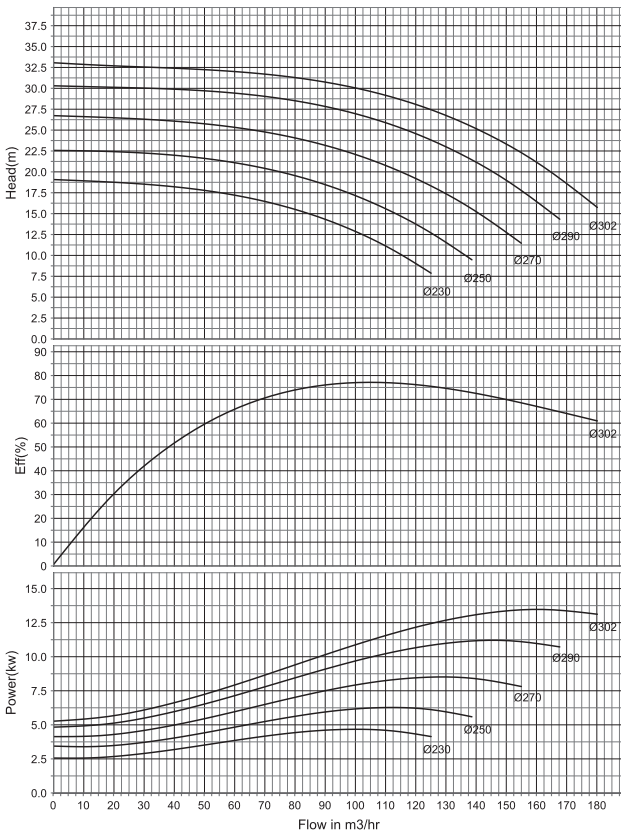

Model : MBH-H-100-125-360

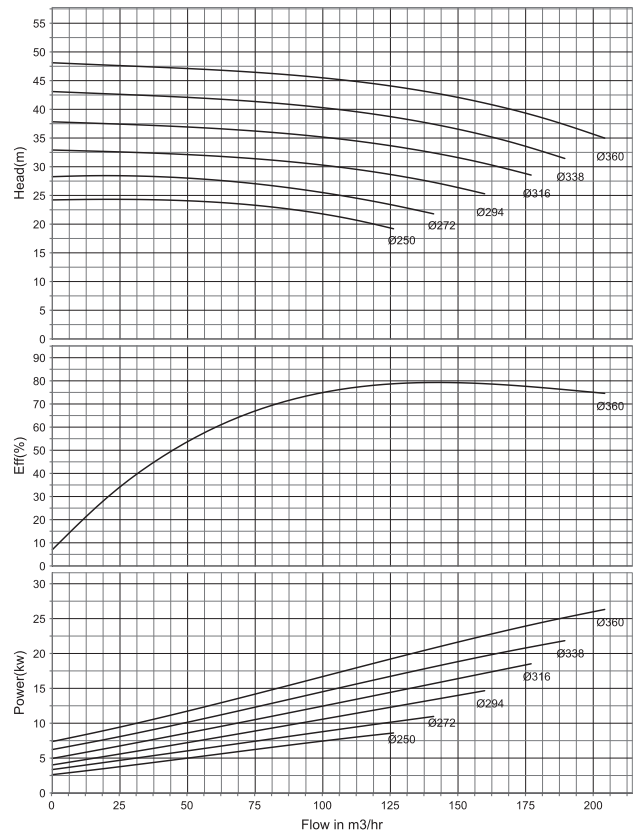

Horizontal Split Casing Pumps

Performance Curves • 1450 RPM (400/440 V, 3 Phase, 50 Hz, A.C. Supply)

Model : MBH-M-125-150-290

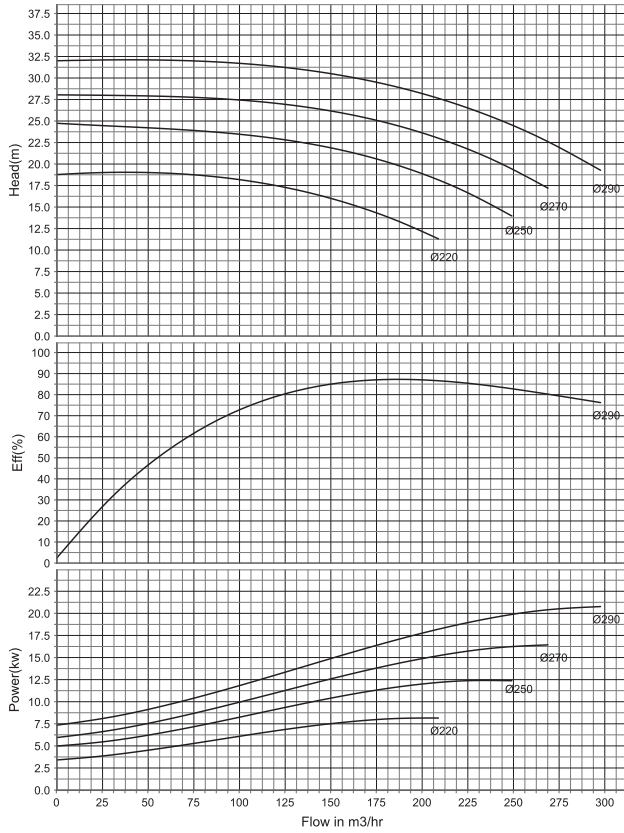

Model : MBH-H-125-150-410

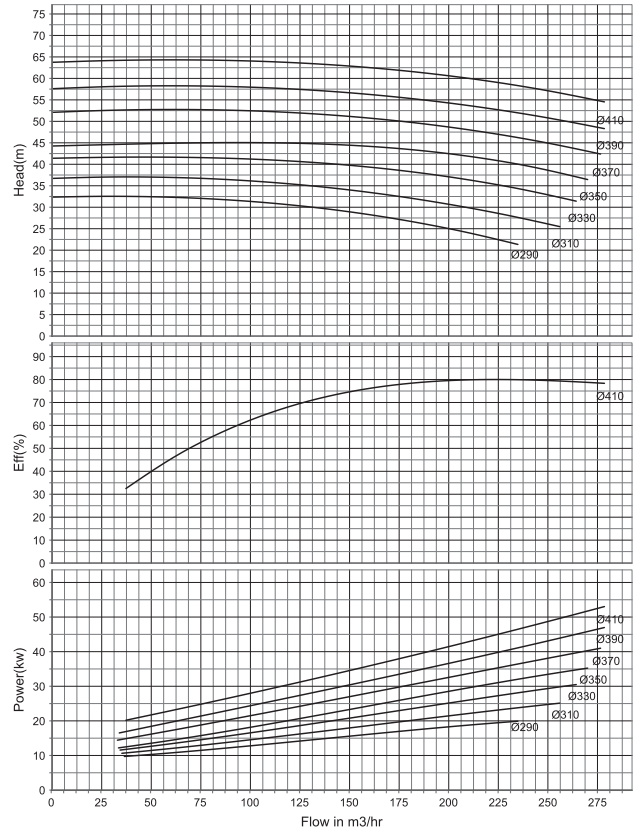

Model : MBH-M-150-200-302

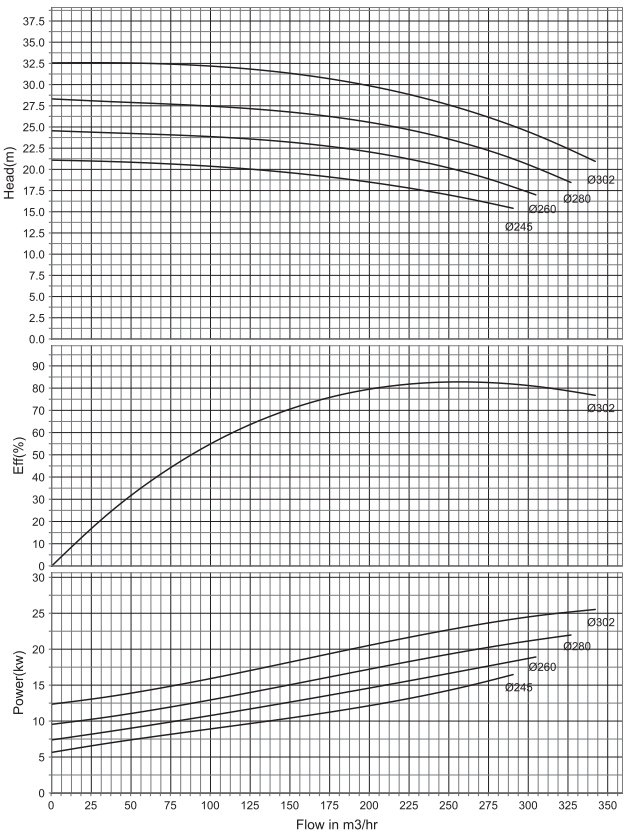

Model : MBH-H-150-200-364

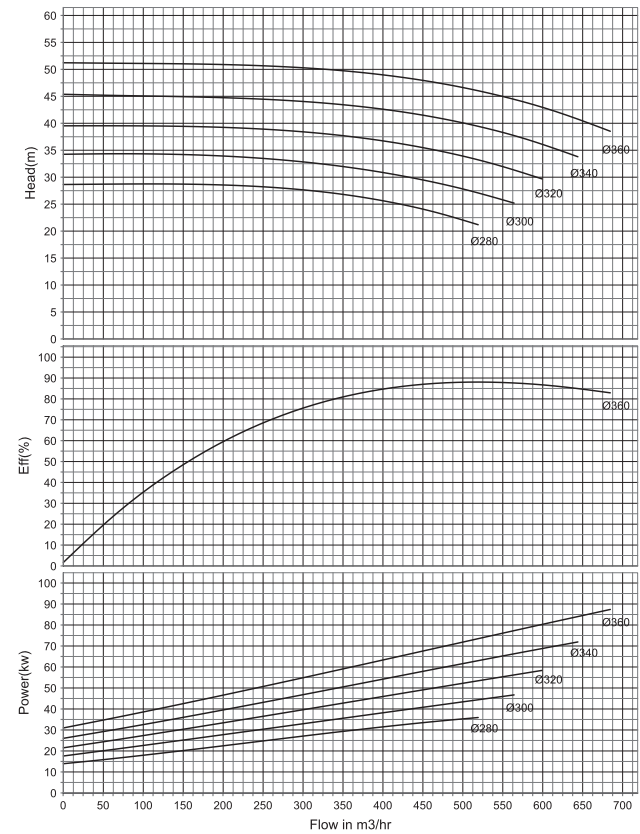

Horizontal Split Casing Pumps

Performance Curves • 1450 RPM (400/440 V, 3 Phase, 50 Hz, A.C. Supply)

Model : MBH-M-200-250-300

Model : MBH-H-200-250-360-360

