



**OPERATION &  
MAINTENANCE MANUAL**

**PORTABLE  
SUBMERSIBLE PUMP**



**MBH<sup>®</sup>  
PUMPS**

*A Mark of Quality*

## CROSS SECTION DRAWING

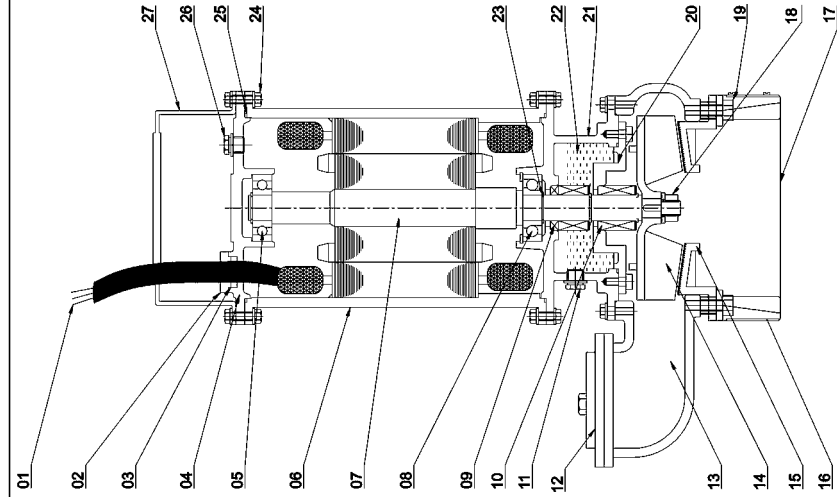

No.	DESCRIPTION	MATERIAL
01	CABLE	PVC.INSU. SHEATHED
02	GLAND COVER	C.I. IS-210, FG260
03	CABLE GROMMET	NITRILE RUBBER
04	TOP COVER	C.I. IS-210, FG260
05	BALL BEARING (N.I.D.E.)	STD. MAKE
06	STATOR	C.I. IS-210, FG260+SI STA.
07	ROTOR SHAFT	S.S.410
08	BALL BEARING (D.E.)	STD. MAKE
09	MECH. SEAL (UPPER)	C / Cr. Steel
10	MECH. SEAL (LOWER)	Si.C. / Si.C.
11	OIL PLUG	S.S.304
12	DELIVERY FLANGE	C.I. IS-210, FG260
13	VOLUTE	C.I. IS-210, FG260
14	IMPELLER	C.I. IS-210, FG260
15	SPIRAL PLATE (WEAR PLATE)	C.I. IS-210, FG260
16	STRAINER	S.S.
17	BOTTOM PLATE	M.S.
18	IMPELLER LOCK NUT	S.S.304
19	ADJUSTING SCREW	S.S.304
20	MECH. SEAL COVER	C.I. IS-210, FG260
21	OIL CHAMBER	C.I. IS-210, FG260
22	OIL	HYLUBE. MILCY-Gr-40
23	EXTERNAL CIRCLIP	SPRING STEEL
24	HEX BOLT	S.S.304
25	'O' RING	NITRILE RUBBER
26	PLUG	S.S.304
27	PUMP HANDLE	S.S.304

## CONSTRUCTION OF PORTABLE SUBMERSIBLE PUMP SET

'MBH' Portable submersible pumps are of close coupled compact design and have pump below and motor above construction hence sump cleaning is possible to the minimum level. These are powered by squirrel cage induction dry motor suitable for operation at 230 Volts & 400 / 440 Volts, 1 Phase / 3 Phase, 50 Hz., A.C. Supply. Being a submersible pump it saves a lot of cost of construction as compare to other conventional pumps & also provides noise free operation. Pumps are fitted with high efficiency free flow impeller for smooth and economical pumping operation. Since these pumps work under pumping liquid suction and are always flooded hence there is no need of priming or suction pipe. Pumps are fitted with double mechanical seal to separate motor chamber from oil chamber and oil chamber from liquid being pumped. Only single phase pumps are provided with float for water level control.

## RECOMMENDATIONS

- Follow maintenance schedule strictly, so as to avoid costly repairs in the long run.
- Ensure that pump set is connected properly to the control panel.
- Portable installation of pump can be done with the help of flexible hose pipe and pump is supposed to pump out liquid.
- If pumping media available is falling short of the pump capacity, it will result in spurt, which is harmful for the pump. In such a case reduce discharge by throttling.
- Ensure that pump rotates in correct direction (clockwise). Counter clockwise rotation will result in lower discharge and increased wear. At the instant the pump is started, it should give an anticlockwise jerk. The rotation of impeller should match the arrow on the pump casing. In case of reverse rotation the current consumption will rise and the pump set will produce unwanted noise.
- Avoid too many creases in the hosepipe, which results in the increase friction losses. Use the shortest possible delivery line.
- Protect cable from damage during storage, transportation and operation. A damaged cable may give shock or burn the motor.
- Always earth the unit, before starting.
- Never hoist the pump set up or down by the connecting cable.
- Use NRV if pipe length is more than 4.5 mtr.

## PRECAUTIONS FOR LONG STORAGE

Clean the pumping set with fresh water and wipe the cable. Put pump set in a cool, dry place in vertical position and cable wrapped be put on top of the pump.

Do not leave cable on the floor where it is likely to get damaged.

## WARNING

- Ensure that pump set rotates in the correct direction of rotation.
- Always operate pump set with the original control panel supplied by the manufacturer.
- Protect the cable from damage.
- Ensure proper earthing of the pump set before starting.

## MAINTENANCE

'MBH' made portable submersible pump set is totally maintenance free. However oil in the seal chamber is to be checked every six months and needs to be replaced if quality gets deteriorated or it is to be changed after one year or 5000 working hours whichever is early.

List of standard oil is as under.

- ◆ BPCL - Hydrol 46 / Turblo 46
- ◆ HPCI - Hylube 30 / milcy 40
- ◆ IOC - Servo super 10

## TROUBLE SHOOTING CHART

							
						<b>PORTABLE SUBMERSIBLE PUMP</b>	
Pump fails to deliver.	The discharge is too low.	The line current is excessive.	The total head is too low.	The power consumption is excessive.	Noisy operation of pump.	CAUSE	REMEDY
						The pump delivers against an excessively high discharge pressure.	Open the isolating valve further, until the duty point conditions have been attained.
						The pump and / or piping are incompletely vented.	Vent the pump & system completely.
						Suction line or impeller clogged.	Remove deposits in the pump & piping.
						Reverse rotation.	Change over two of the phase leads of the power supply cable.
						Excessive wear of the pump internals.	Replace worn components by new one.
						Operating Voltage too low.	Check the supply terminals.
						The motor is running on two phase only.	Replace the defective fuse, check the cable connection.
						The rotor is out of balance.	Clean the rotor, Rebalance the rotor dynamically.
						The motor refuses to run because there is no voltage.	Check the electrical system, inform the supply authority.
						The pump is silted up.	Clean out the inlet, Pump components & check valve.
						Defective motor or cable.	Please consult our works.
						Defective riser pipe.	Replace defective lengths of riser pipe by new ones, fit new gasket.
						Excessive drop in liquid level during operation.	Please consult our works.
						The isolating valve in the discharge line is not fully open.	Open the valve fully.
						Excessive amount of air or gas in the liquid pumped.	Check the operating parameters with reference to duty point. & correctness of submergence.
						Defective Ammeter.	Replace with new one.
						Defective radial bearing in the motor.	Please consult our works.
						Vibration caused by improper installation.	Correct the installation.

# MBH PUMPS

# GUARANTEE

## PORTABLE SUBMERSIBLE PUMP

The pump is guaranteed against defects in material and workmanship under normal use and service for the period of 15 months from the date of purchase or 12 months from the date of commissioning, whichever is less.

The General terms and conditions for above guarantee are :

1. This guarantee is valid only if the pump is operated strictly as per the Instructions given in the user guide attached herewith.
2. Our obligation shall be limited to rectifying; repairing or replacing defective items, ex-works/service station/Authorized Service Center, provided the purchaser has given immediate written notice. The equipment for repairs should be returned to us duly packed, on pre-paid freight basis.

Model : \_\_\_\_\_ Pump Sr. No. \_\_\_\_\_

Customer Name : \_\_\_\_\_

Address : \_\_\_\_\_

Date of Purchase / Bill No.: \_\_\_\_\_

Dealers Name : \_\_\_\_\_

Signature : \_\_\_\_\_ Date : \_\_\_\_\_

**mbh pumps (gujarat) pvt. ltd.**

Plot No. 14, G.I.D.C. Naroda Industrial Estate, Ahmedabad - 382 330, India.

Phone : 079-2282 3066, 2282 1018 • Fax : 079-2282 1511

E-mail : mbhpumpsad1@sancharnet.in • Website : www.mbhpumps.com

# Our Product Range



**SUBMERSIBLE  
SEWAGE  
PUMP**



**HORIZONTAL  
SPLIT CASING  
PUMP**



**POLDER /  
DEWATERING  
PUMP**



**CENTRIFUGAL  
PUMP  
TYPE HC**



**SELF PRIMING  
CENTRIFUGAL  
PUMP**



**ISO 9001:2008**  
*Certified Company*

**MBH<sup>®</sup>**  
**PUMPS**

**mbh pumps (gujarat) pvt. ltd.**  
14, G.I.D.C. Naroda Indl. Estate, Ahmedabad-382 330, India.  
Phone : 079-2282 3066 / 2282 1018  
Fax : 079-2282 1511  
E-mail : [marketing@mbhpumps.com](mailto:marketing@mbhpumps.com)  
Website : [www.mbhpumps.com](http://www.mbhpumps.com)

*A Mark of Quality*